

Floor drain
HELLAS
with 5 optional inlets



Bonomini srl

via ferri, 36 (z.i.) 25010 Borgosatollo (Bs) Italy

Tel. +39 030 2507011, Fax +39 030 2507032, Email: bonomini@bonomini.com

www.bonomini.com

"Hellas" Floor gully with removable hydraulic siphon (water seal : 50 mm) and with non-return mechanical valve that prevents bad smell even in absence of water. Gluable with PVC / ABS glue.

Material: ABS

Colour: black / stainless steel

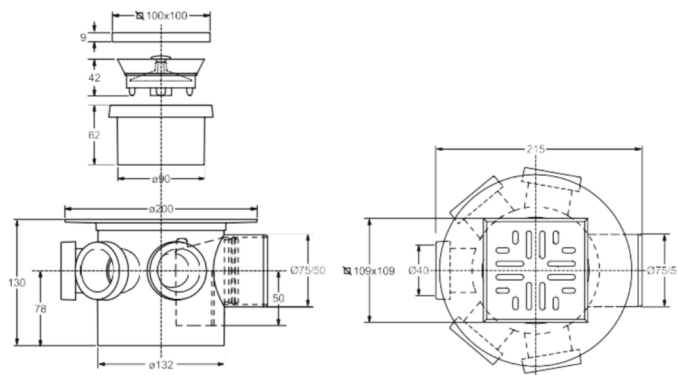

"Hellas" Floor gully with removable hydraulic siphon (water seal : 50 mm) and with non-return mechanical valve that prevents bad smell even in absence of water. Gluable with PVC / ABS glue.

Material: ABS

Colour: black / stainless steel

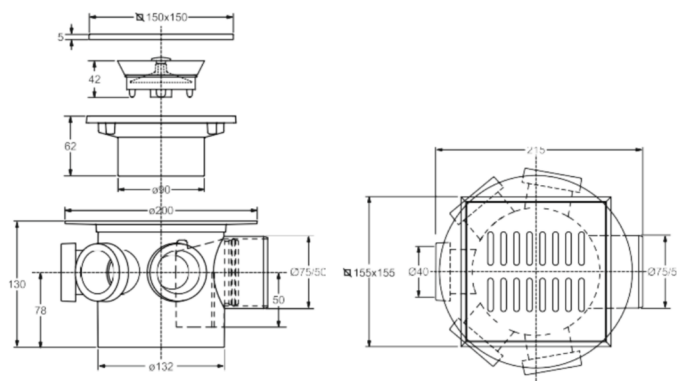
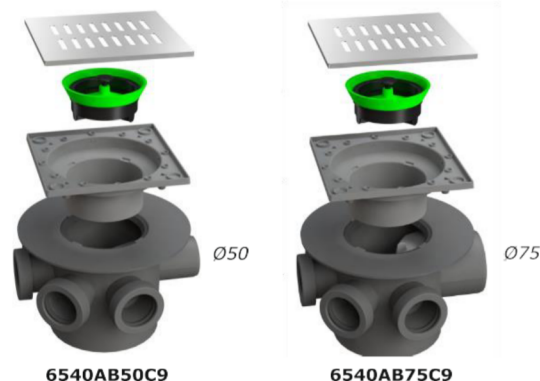

"Hellas" Floor gully with removable hydraulic siphon (water seal : 50 mm) Ø125 mm top female inlet. Gluable with PVC / ABS glue.

Material: ABS

Colour: black / stainless steel

